

Shield - Positive Drain Actuator SD-A

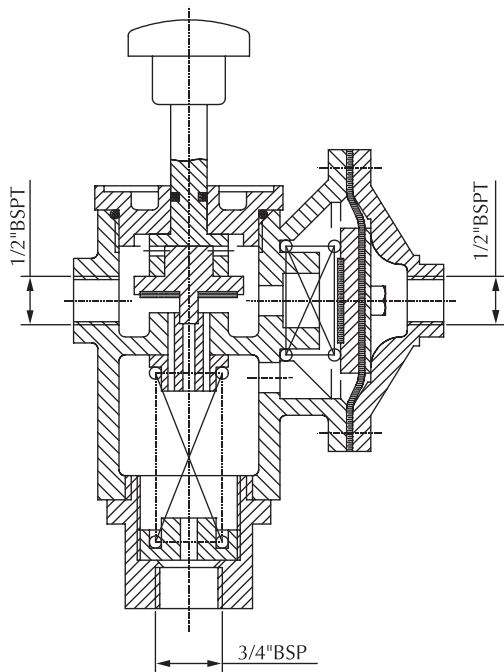

Positive Drain Actuator (PDA) Model SD-A is a device used in dry pilot detection trim for the Deluge Valve. The compressed air connecting the detection line, hold the diaphragm seat and there by holds the water pressure coming through the diaphragm chamber of the Deluge Valve. On release of detection line, when the air pressure drop, the spring lifts the diaphragm seat of the actuator and drains the water of diaphragm chamber of the Deluge Valve. Once the water pressure inside the Deluge Valve diaphragm chamber reach 0.7 Kg./Sq.cm. the direct drain spring lifts the seat and the positive drain continues till the time the actuator is manually reset.

For resetting refer to the resetting procedure of the Deluge Valve.

TABLE - 1

LINE WATER PRESSURE Kg./Sq.cm. MAXIMUM	AIR PRESSURE IN DETECTION LINE Kg./Sq.cm.	
	MINIMUM	MAXIMUM
2	1.5	3.0
4	2.0	3.5
6	2.5	4.0
8	3.0	4.5
10	3.5	5.0
12	3.5	5.0

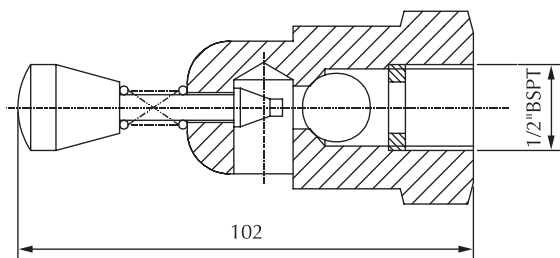

The Drip valve Model SD-A is used with Deluge Valve drip trim. It is used to drain the small leaks through the Deluge Valve seat and it also act as a breather to the equipment. On actuation of Deluge Valve the water pressure causes the ball to close the drip valve.

TECHNICAL DATA :

HOUSING	BRASS IS 319
BALL	SS.304
WEIGHT	0.3 Kg.
WORKING PRESSURE	12.2 Kg. /Sq.cm.

Shield/2005 - Shield reserves the right to change the contents without notice.